

12' x 14' GRADE
LEVEL ROLL UP
DOOR

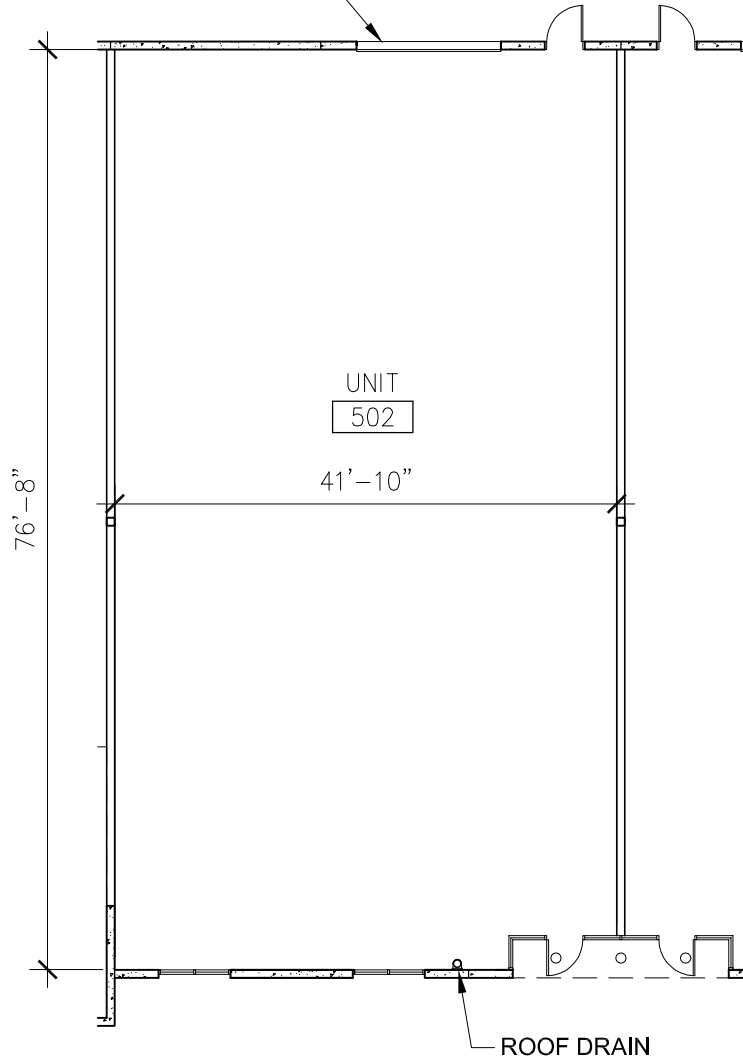

SPECIFICATIONS:

- 24' CLEAR HEIGHT IN WAREHOUSE
- 200 AMP 3 PH. 120/208 VOLT POWER
- FIRE SPRINKLER DENSITY: .45/3000

UNIT 502

1ST FLOOR = 3,315 S.F.
COMMON = 43 S.F.
TOTAL = 3,358 S.F.



BUILDING 5-UNIT 502

CHULA VISTA COMMERCE CENTER

CHULA VISTA, CA



WARE MALCOMB

architecture www.waremalcomb.com
planning p 858.638.7277
interiors

1/16"=1'-0"
5/12/2006